

City of Veneta
MEMORANDUM

DATE: February 4, 2010

TO: Lane County Fire Dist #1
Heather Hill
PO BOX 275
Veneta, OR 97487

FROM: Zac Moody, City of Veneta

RE: *Site Plan Amendment – Tom’s Courtyard (SR-6-09)*
Assessors Map 17-05-31-23 Tax Lot 2700

Location Address: 88115 Territorial Hwy, Veneta, Oregon 97487

The City has received a request for a Site Plan Amendment proposing to add a food vending unit adjacent to the existing vending unit.

This request is being forwarded for your review, comment and conditioning. If you have conditions of approval you would like incorporated into the City’s consideration of this request, please list them and return to this office ***no later than*** February 18, 2010.

Please reference file number SR-6-09 in your reply.

- We are not affected by the proposal.
- We have reviewed the proposal and have no comments.
- Our comments are attached.
- Our comments are:

110 ft

- Retail Store - 5
- Los Primos - / 1
- Tom's Market - / 1
- Flower Shed - / 1

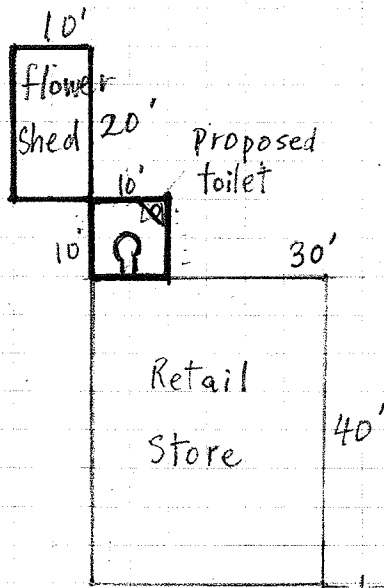

235 ft

Handicap Ramp
Parking

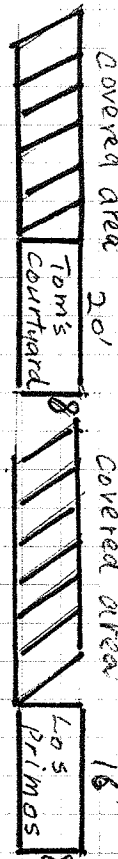
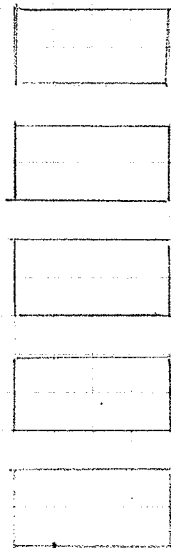
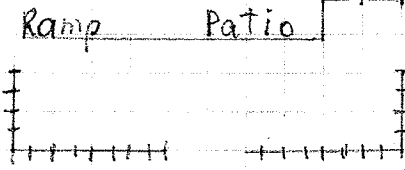

Fence

Exit
↓

sign

Enter
↑

1 cm = 10 ft

88115 Territorial
VA no ta.

December 10, 2009

City of Veneta
88184 8th Street
P.O.Box 458
Veneta, OR 97487

Zac Moody
Assistant Planner

Dear Sir,

First, we would like to apply for the Permanent Permit for the use of our Concession Food Trailer.

Secondly instead of constructing a new Flower Stand as it was permitted in 2004, we would like to use the storage shed for the same usage.

Lastly we would also like to build 2 covered areas along the south side of the property for sitting purpose & also an out house 10 by 10 use as a toilet.

Shawn Eaton dropped by this morning & did some inspections. Everything looked fine to him. All we need now is a building permit.

Enclosed please find (1) Site Plan Minor Amendment Application &
A check of \$ 700.00
(2) A new Site Plan
(3) Plan of the Storage Shed
(4) Plan of the Out House
(5) Drawing of the covered areas

Thank you very much for your assistance. Looking forward to hearing from you soon.

Sincerely,

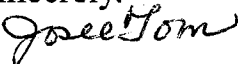
Josee Tom

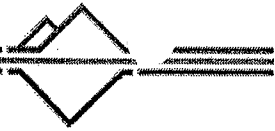

**GENERAL
 LAND USE APPLICATION**

Receipt # _____ Letter of Intent Received _____
 Submission Date _____ Associated File # _____
 Planning File # _____

Print Property Owner Name: William & Josee Tom Phone: (541) 935-0029
 Mailing Address: 25512 Josee Lane, Veneta, OR 97487
 Print Applicant (if not owner): N/A Phone: _____
 Mailing Address: _____
 Print Agent: N/A Phone: _____
 Mailing Address: _____

Assessor's Map Number (Township, Range, Section, Quarter Section)	Tax Lot(s)	Acres	Zone
<u>17-05-31-23</u>	<u>2700</u>	<u>.61</u>	<u>CC</u>

Subject property address(es): 88115 Territorial Rd, Veneta, OR 97487
 Subzone (if applicable): _____

Check all applicable APPLICATIONS and DEPOSITS below

Technical Review/Public Notice Deposit (for ALL applications except Property Line Adjustments) \$350

APPLICATION DEPOSITS (Application fees are calculated by ACTUAL PROCESSING COSTS)

SITE PLAN REVIEW

PLANNED DEVELOPMENTS

<input type="checkbox"/> Site Plan Review/Major Amendment	\$1,350	<input type="checkbox"/> Conceptual Plan	\$350
<input checked="" type="checkbox"/> Site Plan Minor Amendment (Administrative)	\$350	<input type="checkbox"/> General Development Plan	\$550+25/unit
<input type="checkbox"/> Site Plan Minor Amendment (Planning Commission)	\$450	<input type="checkbox"/> Final Development Plan	\$300

OTHER APPLICATIONS PROCESSED WITH DEPOSITS

<input type="checkbox"/> Conditional Use Permits (Note: Some Conditional Use Permits also require a Site Plan Review)	\$775
<input type="checkbox"/> Specific Area Plan Amendment – NE Employment Center & Southwest Area Plan (/SDP)	\$7,500
<input type="checkbox"/> Variance to the Veneta Wetland Protection Ordinance (Veneta Municipal Code Chapter 18.10)	\$700

APPLICATIONS WITH FIXED FEES (These are non-refundable)

<input type="checkbox"/> Appeals	\$525	Amendments (except Specific Area Plan above)	
<input type="checkbox"/> Variance	\$425 x () Provisions = Total Fee	<input type="checkbox"/> Comprehensive Plan (text only)	\$800
		<input type="checkbox"/> Ordinance (text only)	\$200
		<input type="checkbox"/> Zone Change (map only)	\$600
		<input type="checkbox"/> Plan Designation & Zoning Map	\$1,000

I HEREBY STATE THAT THE FACTS RELATED IN THE ABOVE APPLICATION AND THE PLANS AND DOCUMENTS SUBMITTED HERewith ARE TRUE, COMPLETE, CORRECT, AND ACCURATE TO THE BEST OF MY KNOWLEDGE.

Property Owner Signature: _____

Applicant Signature: Josee Tom